

Casambi Dimmer 200W / LD220WCM

Smart trailing edge dimmer with freely programmable pushbutton connection



Article no.: 1046

Description

The dimmer is a high quality trailing edge phase dimmer for dimmable resistive and capacitive high voltage loads. It controls individual luminaires in the Bluetooth Low Energy Mesh network without the use of gateways, routers, repeaters or extra cabling. The dimmer can be used with loads of up to 200W. The pushbutton can be adjusted, e.g. luminaire, device, group, scene/animation or all luminaires can be controlled by the pushbutton. Configuration is wireless via the Casambi App. The installation must only be carried out by a qualified electrician.

- Wireless control via app, wall switch and motion detector
- Automatic switching on and off according to time, weekday, date or sunshine
- Pushbutton connection freely programmable
- Group function
- Integration in scenes and animations
- iBeacon can be activated

Technical Details

Description	Features
Operating voltage	220-240 VAC / 50 Hz
Radio frequencies	2,4...2,483 GHz / +4 dBm
Mains current	0,87 A
Dimm-method	Trailing-edge
Wire range, solid & stranded	1,0 mm ² - 2,5 mm ²
Wire strip length	6-8 mm
Ambient temperature, ta	-20...+50 °C
Storage temperature	-20...+70 °C
Degree of protection	IP20
Protection class	II
Weight	31 g
Housing material	Flammhemmendes Polycarbonat
Pushbutton function	Adjustable via app
Dimensions	49 x 50 x 16 mm

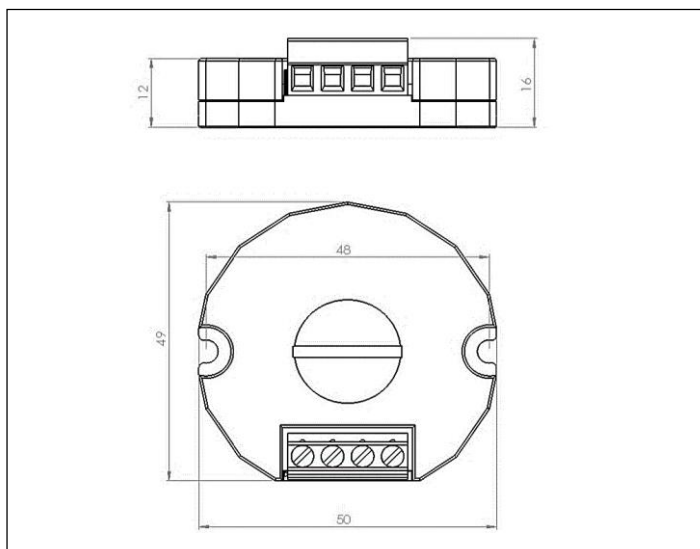
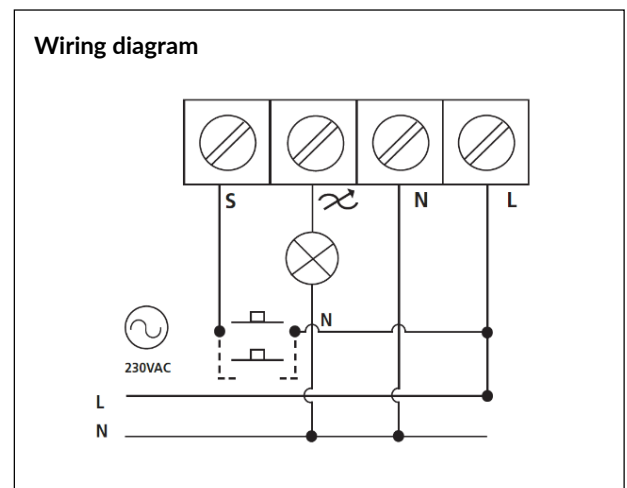

Declaration of Conformity:

Hereby Vadsbo LightTech AB declares that the product Dimmer 200W/ VD220WCM is in compliance with ROHS Directive 2011/65/EC, RED 2014/53/EU and EC No. 1907/2006 REACH. The detailed declaration of conformity can be found at <https://www.aimotion-smartliving.de/en/support-en/download/> in the product category Dimmer.

Note

Technical changes and errors excepted. 03.2021.

